



JOHNSTON COUNTY ENVIRONMENTAL HEALTH

Application for Septic System and Well

309 East Market Street, NC 27577

Phone: 919-989-5180 Fax: 919-989-5190

Email: septicwellapplication@johnstonnc.com

FOR OFFICE USE ONLY:

Date Received: _____

Application #: _____

Received By: _____

Application and Plan Submittal: A completed Application, Site Plan, Zoning Document from appropriate zoning district and Fee must be submitted to the Johnston County Environmental Health Office. This packet may be submitted in person, by email at the email address given above, by U.S. Mail, Fed Ex, UPS, or other mail service. Once the application packet is received; you will be contacted for payment processing which can be completed over the phone with a card, by mail or in person. If the application is incomplete then you will be contacted with of list of deficiencies. An application, site plan, zoning document and fee must be submitted for each individual lot.

Septic Application (Check One): New System Re-inspection Repair Supply Line Replacement Upgrade Revision of System Relocation
Well Application (Check One): Drinking Water Well Irrigation/Agricultural Well

APPLICANT INFORMATION:

Applicant Name and Contact Person _____ Email: _____
Address: _____ Phone: _____

OWNERS INFORMATION: Same as Applicant Information

Owner's Name: _____ Email: _____
Address: _____ Phone: _____

SITE INFORMATION:

Parcel #: _____ Zoning Jurisdiction: _____ Total Acreage: _____ Lot #: _____
Subdivision Name: _____ Street Address: _____
Driving Directions to the property: _____

PROJECT INFORMATION:

Facility Type: _____
Residential Use: Number of Bedrooms: _____ Foundation Type: _____
Commercial Use: Square Footage of Bldg. _____ # of Employees: _____ #of Seats: _____
Indicate Desired System Type: Any Gravel Accepted Alternative Innovative Other: _____

WATER SUPPLY:

New Well Existing Well Community Well Public Water

Applicant Signature:

Date:

If the applicant is NOT the owner, an OWNERS CONSENT form shall be included with this application. The form can be found on our website.

I understand that any false, inaccurate, or incomplete information provided by me or the applicant may result in the denial, revocation or administrative withdrawal of this application, request, approval or permits. I further agree to all terms and conditions which may be imposed as part of the approval of this application for service. I certify that I have read and examined this application and know the same to be true and correct. All provisions of laws and ordinances covering this type work will be complied with whether specified herein or not. The granting of a permit does not presume to give authority to violate or cancel the provisions of any other state or local law regulating construction. The owner/applicant will notify the Health Department if this property contains designated wetlands or if the nature of the waterway changes. Additionally, I grant permission to perform the above requested services and certify that I fully acknowledge and understand that this application is merely an application for service and does not authorize installation or construction activity to begin until the completed application has been evaluated and approved by issuance of an appropriate permit signed by a duly authorized county official. Any site preparation or excavation or other installation of construction activity that I might do prior to the approval and issuance of a valid and appropriate permit (or any other time without a lawfully issued permit) shall be at my own risk and any excavation, building, structure or other improvements not in compliance with all applicable county policies, or laws may be cause to remove, revised or otherwise brought in to conformity at my own expense or cause the permit to be revoked. I as applicant agree to all terms and conditions which may arise as part of the approval of this application and the issuance of Environmental Health permits.

Johnston County Environmental Health

Application for Septic System and Well

The Applicant shall notify the local health department upon submittal of this application if any of the following apply to the property in question. If the answer to question 1, 2, 3, 4, 5 is "YES", applicant must attach supporting documentation or provide a brief description of the issue in the space provided.

1.) Is this application for an EOP (Engineered Option Permit)?	YES	NO
2.) Is this a L.S.S. option permit?	YES	NO
3.) Does the site contain any jurisdictional wetlands?	YES	NO
4.) Does the site contain any existing wastewater systems?	YES	NO
5.) Is any wastewater going to be generated on the site other than domestic sewage?	YES	NO
6.) Is the site subject to approval by any other public agency?	YES	NO
7.) Are there any easements or right of ways on this property?	YES	NO
8.) Have the property corners been staked?	YES	NO
9.) Has the house and any additional structures been staked?	YES	NO
10.) Has the property been cleared or has underbrush been cut?	YES	NO
11.) Will there be a basement?	YES	NO
12.) Are there plumbing fixtures in the Basement?	YES	NO
13.) Is there an existing well on the property? <small>Please make sure to include on site plan if applicable.</small>	YES	NO
14.) Is your foundation type a Slab or a Stem-Wall?	YES	NO

Description:

Please note:

The Septic System and any other improvements or conditions shall be installed and maintained as indicated on the permit issued. This permit shall in no way be taken as a guarantee or implied warranty that the septic system will function for any given period of time or that representatives of the Health Department assume any liability for related damages, consequential or direct, which are caused or which may be caused by a malfunctioning or such system.

Johnston County Environmental Health

Application for Septic System and Well

Preparing your Property for Evaluation:

The following instructions are for your guidance and should not be submitted with your application.

- A completed Site Plan (instructions to follow)
- For New System Evaluations:
 - Property must be cleared (mowed, bush-hogged, etc.) to permit easy access. This may require mowing tall weeds in a field or cutting bushes and limbing trees in a wooded area. If wooded lots are cleared, it is very important not to disturb existing soil or reshape lots in any way. Clearing with heavy equipment should only be done in dry conditions. Disturbance of soil may cause sites to be unsuitable for a septic system or may require a more expensive system. A permit that has been issued could be revoked due to site disturbance or construction in the area permitted for the septic system or repair area.
 - Property corners must be flagged. If owner/agent cannot find irons, then a licensed surveyor may be hired by the applicant to identify irons.
- For Repair Evaluations:
 - Please indicate on the application what type of problem you are having (backing up in the house, in the yard, at the tank, etc.).

Example of a Site Plan required for submittal of a Septic Application:

This example was prepared to assist you in drawing your own site plan for your property. Without your site plan we cannot perform the site evaluation. If you have any questions, please call us at (919) 989-5180.

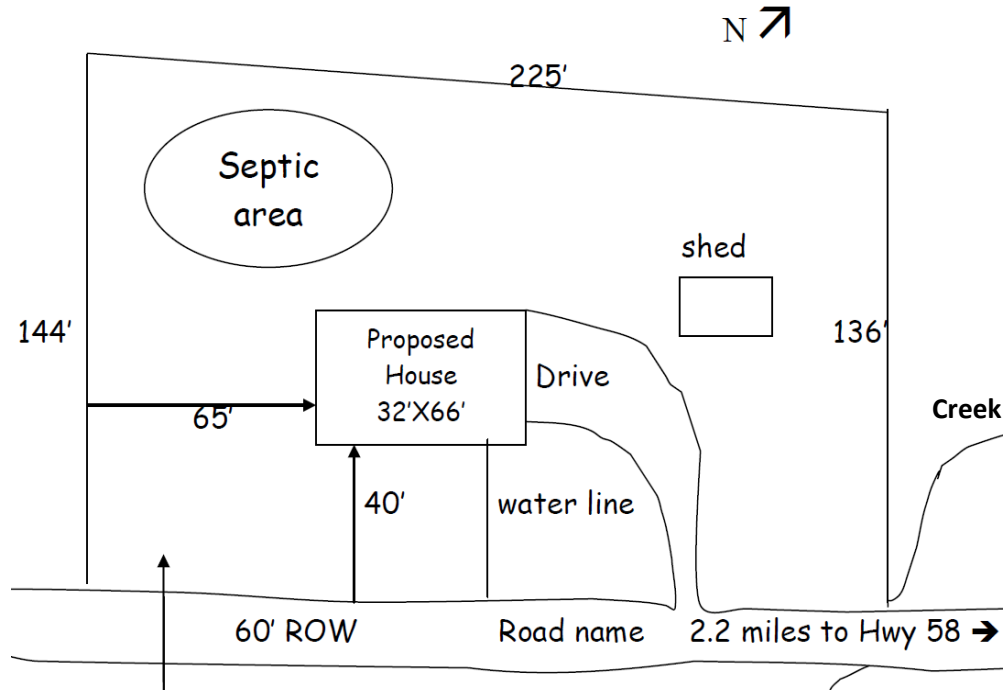

Make sure to indicate the following items on the site plan:

- Property Dimensions
- Proposed location of all structures on the property (garages, workshops, outbuildings, pools, water lines)
- The site you would prefer your septic permit to go
- The preferred location of the driveway
- The proposed well location
- A north arrow or other sufficient directional indicator
- The location of any existing septic tanks within 100 feet of your property line
- The location of any easements or rights of way on the property or any designated wetlands.